

DELUXE 12" AREA/FLOOD INDUCTION LUMINAIRE

The Deluxe Area/Flood Induction Luminaire utilizes a soft-cornered design to provide excellent light distribution and an aesthetically appealing appearance. Ideal for storage areas, rail yards, loading docks, road lighting, parks, and perimeters.

Product Specifics

Light Source	One 40 Watt Induction Lamp
Lumens	2800 Lumens
Color Temperature	5000K
CRI	>80 (Ra)
Input Voltage	120 or 277 VAC, 50/60Hz
EPA Calculation	.55
Fixture Weight	19 Lbs.
Rated Life	100,000 Hours
Warranty – Housing Components	2 Year Limited
Warranty – Lamp and Ballast	10 Year Limited
Ratings	UL, CSA, CE, FCC, ISO, IP65

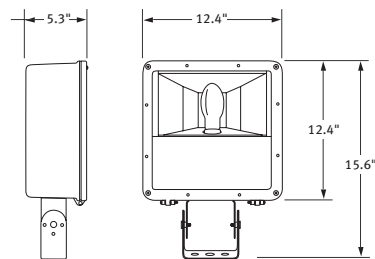

Detailed Specifications

CONSTRUCTION

Features a durable, corrosion-resistant, die-cast aluminum 12" enclosure with an architectural bronze powder coated finish. Enclosure is fully sealed and gasketed, and is Wet Location Listed for outdoor use and includes corrosion-resistant hardware. Features an internal, anodized aluminum reflector which provides ideal 7H x 7V general light distribution, and the lamp is protected by a high-impact, heat-resistant tempered glass lens.

ELECTRONICS

Utilizes an electronic ballast, producing a high-frequency current, controlled by an integrated circuit (IC) chip allowing a power factor of up to 99%. Minimum operating temp of -25°C (-13°F), maximum operating temp of 50°C (122°F).

LAMPS (Included)

Available with (1) 40W rectangular induction lamp that provides 2800 initial lumens per lamp. The induction lamps have a 5000K color temperature, provide a CRI of >80 (Ra) and have a 100,000 hour rated life. Lamps and Ballasts are listed and certified by CE, FCC, UL, ISO and also meet the Electromagnetic Compatibility (EMC) standard.

INSTALLATION

Ideal for mounting to any surface and comes complete with 6" pole mount bracket (M6SS). Cover is hinged for easy access to lamp and internal components. Dark Sky compliant when mounted horizontally.

Specifications are subject to change without notice.

Photometrics

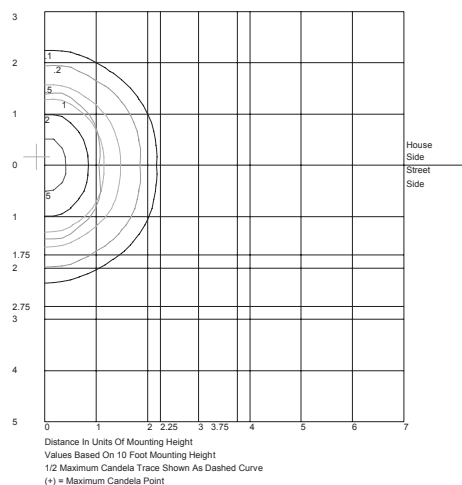

Ordering Information

Model	Lamp	Volts	Mounting Arms* Square Pole	Mounting Arms* Round Pole	Options
DXFL50	IND40	120 = 120V	M6SS = 6"	M6SR = 6"	PC1 = 120V Photocell
		277 = 277V	M10SS = 10"	M10SR = 10"	PC2 = 277V Photocell
			M12SS = 12"	M12SR = 12"	SF = Slip Fitter Mount
			M18SS = 18"	M18SR = 18"	SB = Swivel Bracket
					HD = Heavy Duty Direct Pole Mount

Ordering Example: DXFL50-IND40-120-M6SS-PC1
 *Luminaire comes standard with an M6SS Mounting Arm

Accessories Field Installed**

- PC1 = 120V Photocell
 - PC2 = 277V Photocell
 - SF = Slip Fitter Mount
 - SB = Swivel Bracket
 - HD = Heavy Duty Direct Pole Mount
 - FL50WG = Wireguard
 - FL50GS = Glare Shield
 - FL50LG = Clear Vandal Guard
- **Order as a separate line item

