

VANDAL RESISTANT INDUCTION GARAGE LIGHTER

The Vandal Resistant Garage Lighter Induction Luminaire is ideal for warehouses, manufacturing facilities, garages, walkways, under passes, loading docks. This fixture gives out even illumination on both horizontal and vertical planes.

Product Specifics

Light Source	One 40 Watt Induction Lamp
Lumens	2800 Lumens
Color Temperature	5000K
CRI	>80 (Ra)
Input Voltage	120 or 277 VAC, 50/60Hz
Fixture Weight	12 Lbs.
Rated Life	100,000 Hours
Warranty – Housing Components	2 Year Limited
Warranty – Lamp and Ballast	10 Year Limited
Ratings	UL, CSA, CE, FCC, ISO

Detailed Specifications

CONSTRUCTION

Features a durable, corrosion-resistant, die-cast aluminum enclosure with an architectural bronze powder coated finish. Enclosure is fully sealed and gasketed, and is Wet Location Listed for outdoor use and includes corrosion-resistant hardware. Features an internal, white steel reflector which provides ideal light distribution, and the lamp is protected by a vandal-resistant, polycarbonate prismatic refractor.

ELECTRONICS

Utilizes an electronic ballast, producing a high-frequency current, controlled by an integrated circuit (IC) chip allowing a power factor of up to 99%. Minimum operating temperature of -25°C (-13°F), maximum operating temperature of 50°C (122°F).

LAMPS (Included)

Available with (1) 40W round induction lamp that provides 2800 initial lumens per lamp. The induction lamps have a 5000K color temperature, provide a CRI of >80 (Ra) and have a 100,000 hour rated life. Lamps and Ballasts are listed and certified by CE, FCC, UL, ISO and also meet the Electromagnetic Compatibility (EMC) standard.

INSTALLATION

Ideal for mounting to any horizontal surface and features 1/2" NPT entry points for conduit access.

Specifications are subject to change without notice.

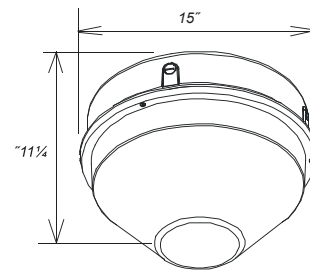

Photometrics

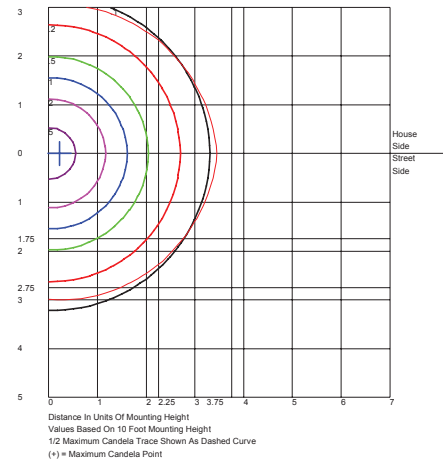

Ordering Information

Model	Lamp	Volts
DXVNG40	IND40	120 = 120V 277 = 277V
Ordering Example:	DXVNG40-IND40-120	

Accessories* Field Installed

- VNQM = Hinged Quick-Mount Bracket
- CPSPS = Swivel Pendant Mount (Square Box)
- CPSPR = Swivel Pendant Mount (Round Box)
- PMJB = Offset Pendant Mount J-Box
- VNGL40PC = Replacement Lens
- VNGL30PM = Pendant Mount**

*Order as a separate line item