



HLEMR16

LED Hazardous Location Emergency Unit



PROJECT: _____
 FIXTURE TYPE: _____
 LOCATION: _____
 CONTACT/PHONE: _____



DIMENSIONS

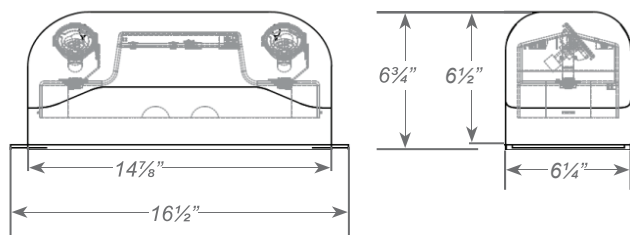

ILLUMINATION

- Two fully adjustable, ultra bright 3.3 watt high performance MR-16 base LED lamp heads for optimized center-to-center spacing.

MOUNTING

- Die-cast mounting brackets provided for surface wall-mount installation.
- Pre-installed conduit hub for conduit and pendant-mount installation.

HOUSING

- Housing is fiberglass reinforced polycarbonate construction in gray finish.
- Corrosion-resistant enclosure with one piece, high-impact resistant, UV stabilized polycarbonate lens and molded gasket with stainless steel screws.

ELECTRICAL

- Dual 120/277 voltage.
- Unique bi-color LED indicator light alerts occupant on battery condition (Green-normal, Red-check-battery).
- Charge rate/power "ON" LED indicator light and magnetic test switch for mandated code compliance testing.
- 6V/12V maintenance-free, rechargeable NiCd battery.
- Offers 7.8W of remote capacity (6V/12V DC output) standard
- Internal solid-state transfer switch automatically connects the internal battery to LED lamp heads for minimum 90-minute emergency illumination.
- Fully automatic solid-state, two-rate charger initiates battery charging to recharge a discharged battery in 24 hours.

OPTIONS

- SDT: Self-diagnostic feature performs monthly, biannual, and annual tests to ensure reliable operation and meets electrical and life safety codes.
- CW: Optional internal heater and battery blanket for extreme cold temperature applications (-20°C – 50°C).
- TP: Tamper-proof hardware helps discourage unauthorized access to the unit.

WARRANTY/LISTINGS

- Five year warranty on all electronics and housing. Batteries prorated for five years.
- Meets UL924, NFPA101 Life Safety Code, NEC, OSHA, Local and State Codes.
- IP66 rated for Ingress protection.
- Rated for Class 1, Division 2, Groups A, B, C & D
- UL listed for wet locations (0°C – 50°C).



ORDERING INFORMATION

Model	Battery Voltage	Wattage	Housing Color	Options
HLEMR16	6 = 6 Volt	15 = 15 watts	G = Gray	SDT = Self-Diagnostics
	12 = 12 Volt			CW = Cold Weather
				TP = Tamper-proof

Ordering Example: HLEMR1615G



HLEMR16

LED Hazardous Location Emergency Unit



PROJECT: _____
FIXTURE TYPE: _____
LOCATION: _____
CONTACT/PHONE: _____

REMOTE LAMP COMPATIBILITY

Reference remote lamp head specification sheets for complete catalog number ordering information.

MODEL NUMBER	BATTERY	REMOTE CAPACITY	HLRHLED16	ASR-LED*	R-ASRLED*
HLEMR16	6V, 12V	7.8W	X	X	X

*Not Class1 Division 2 rated. For use in non-hazardous locations only.

ELECTRICAL INFORMATION

HLEMR16 Series Model with Input Voltage Rating	VAC (V)	Hz	Max. Current (A)	Max. Power (W)
6V battery version	120	60	0.12	13.6
	277	60	0.06	16.9
12V battery version	120	60	0.11	12.5
	277	60	0.06	15.1