

CHEL Series City of Chicago Edge-lit LED Exit

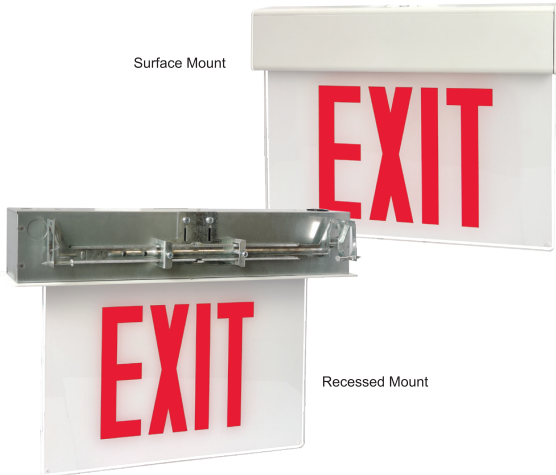

PROJECT: _____
 FIXTURE TYPE: _____
 LOCATION: _____
 CONTACT/PHONE: _____



FEATURES

- Suitable for City of Chicago Emergency EXIT requirements
- Exit illuminated with high-output, long-life white LEDs
- Universal input voltage from 120VAC to 277VAC, 50/60Hz
- Recessed or surface mount

SPECIFICATIONS

Illumination

Long-life, high-intensity, white LEDs

Construction

Surface mount: Extruded aluminum housing (steel canopy included)
 Recessed mount: 20 Gauge steel housing with a white powder coated finish on an extruded aluminum trim plate (galvanized steel hanger bar assembly included)

Input

Universal input, 120 to 277VAC, 50/60Hz

Battery

Maintenance-free LiFePO4 battery

Run Time

UL Listed 90 minute emergency run time, 24 hour recharge time

Electrical

Low voltage disconnect eliminates deep discharge, brownout protection, overload and short circuit protection

Legend

Fully illuminated red 6" characters with 3/4" stroke; ships standard with single-face CHEL-PANEL-3 (EXIT with no arrows)

Mounting

CHEL-S can be ceiling, end or wall mounted (canopy included) as well as pendant (by others) mounted; CHEL-R can be recessed mounted into ceiling or wall.

Finishes

White

Certifications

UL 924 Listed, meets or exceeds City of Chicago, NEC requirements and NFPA 101

Warranty

Any component that fails due to a manufacturing defect is guaranteed for five years, with a five year prorated warranty on the battery. The warranty does not cover physical damage, abuse or instances of uncontrollable natural forces. See the full Mule warranty document for detailed information. (Terms and conditions apply)

PRODUCT DESCRIPTION

The CHEL Series LED edge-lit exit is City of Chicago approved and offered in surface or recessed mount configurations. The CHEL is available as AC-only or self-powered models featuring a Lithium Ion class battery that operates for a minimum of 90 minutes during a power outage. The recessed fixture is constructed with an extruded aluminum housing with a 20-gauge steel housing. The surface mount version utilizes an extruded aluminum housing and includes a steel canopy. Both versions are UL 924 compliant and come standard with a single-face, acrylic EXIT panel. A full range of alternative, field-installable, single- or double-face acrylic panels are available as accessories.

DIMENSIONS

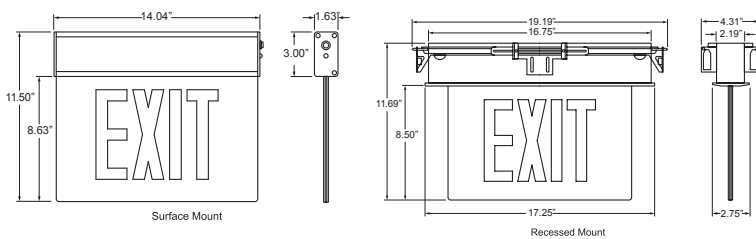

ORDERING INFORMATION

Model	Mounting	Power Source	Finish	Single-Face Panel Accessories ^{2,3,5}	Double-Face Panel Accessories ^{2,4,5}
CHEL ¹	S = Surface R = Recessed	LB = AC Only WB = With Battery	WH = White	CHEL-PANEL-3 = EXIT (included) CHEL-PANEL-6 = EXIT ▶ CHEL-PANEL-9 = EXIT ◀ CHEL-PANEL-12 = EXIT ◀ ▶ CHEL-PANEL-2 = STAIRS CHEL-PANEL-5 = STAIRS ▶ CHEL-PANEL-8 = STAIRS ◀ CHEL-PANEL-11 = STAIRS ◀ ▶	CHEL-PANEL-18 = EXIT CHEL-PANEL-21 = EXIT, EXIT ◀or▶ CHEL-PANEL-24 = EXIT ◀ ▶ CHEL-PANEL-17 = STAIRS CHEL-PANEL-20 = STAIRS, STAIRS ◀or▶ CHEL-PANEL-23 = STAIRS ◀ ▶

Notes:

- ¹ Come standard with single-face EXIT Panel-3 (no arrows)
- ² All panels supplied with red letters on a white background
- ³ One faceplate only
- ⁴ Two faceplates
- ⁵ Order as separate line item

Mounting Accessories⁵ (Field Installed)
 PVT-PENDANT-ADAPTER = Pendant Adapter

ORDERING EXAMPLE: CHEL-S-WB-WH

CONSTRUCTION

The CHEL-S (surface mount version) utilizes an extruded aluminum housing and an included steel canopy. The CHEL-R (recessed mount version) utilizes a 20 Gauge steel housing supplied with a galvanized steel adjustable hanger bar assembly. An extruded aluminum trim plate is included on the recessed mount version. Both versions are supplied standard with a white powder coat finish on viewable surfaces.

PANELS

Constructed of clear, impact and scratch-resistant, optical-grade acrylic panels with white background and red silk-screened lettering. Stencil letters are 6" high with 3/4" stroke as required by UL 924 standard.

ILLUMINATION

High-intensity white LEDs provide superior brightness with energy consumption of less than 5W. LEDs are a maintenance-free lighting solution with an estimated life of up to 100,000 hours.

ELECTRICAL

Input

Universal input voltage 120 to 277VAC @ 50/60Hz. Overload and short circuit protection included.

LiFePO4 Battery

Maintenance-free, long-life, rechargeable LiFePO4 batteries. Fully automatic, solid-state charger initiates battery charging to recharge a discharged battery within 24 hours. The internal solid-state transfer switch automatically connects the internal battery to power the LED board for a minimum of 90 minutes of illumination during the loss of utility power. An LED indicator light alerts occupant on battery condition (Steady-normal, Blinking-check battery).

Emergency

The CHEL Series exit will operate for a minimum of 90 minutes during a loss of power with a 24 hour maximum recharge time for the battery.

Brownout Circuit

Brownout circuit monitors the line voltage. As the line voltage sags and can no longer illuminate the exit sign to meet UL 924 visibility test, the emergency circuit will turn on to supply a portion or all the power to illuminate the sign for 90 minutes until the line voltage is restored.

Low Voltage Disconnect

Low Voltage Disconnect (LVD) measures the battery terminal voltage. The LVD continuously monitors the battery terminal voltage and if it should fall below a preset voltage threshold, the LVD will disconnect the load. When the battery is recharging and voltage is raised above another preset voltage threshold, the load is automatically reconnected.

Test Button

The test button is easy to locate and provides manual verification of the transfer circuit and emergency lamps.

INSTALLATION

Installs in minutes with easy-to-read instructions and detailed diagrams. A steel canopy is provided for wall, ceiling or end mounting for surface mount versions. The surface mount version also includes knockouts on top for pendant mounting. The recessed version can be ceiling or wall mounted. No special hardware or tools necessary. Internally housed components and battery.

CONFORMANCE TO CODES & STANDARDS

The CHEL Series is UL 924 Listed and meets or exceeds the following: City of Chicago Fire Code, NEC requirements and NFPA 101.

PENDANT ADAPTER

